

Product presentation

FG ceramic elbows and pipes

decrease your production costs
minimize downtime



seamless and segmented ceramic

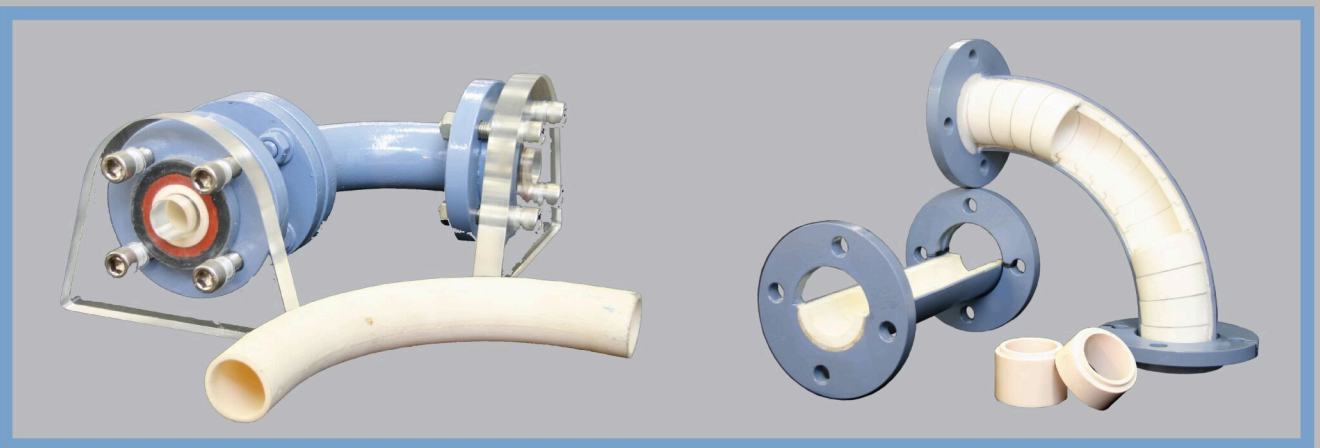

**solution for
pneumatic
conveying**

shipping address: Am Sinnerhoop 70 · 58285 Gevelsberg / Germany · Tel +49 2332 544360
registered office: Deller Str. 16 · 58339 Breckerfeld / Germany · Tel +49 2338 5919710

website: <https://www.friedrich-gerke.de>
e-mail: info@friedrich-gerke.de

Technical description

FG ceramic elbows and pipes

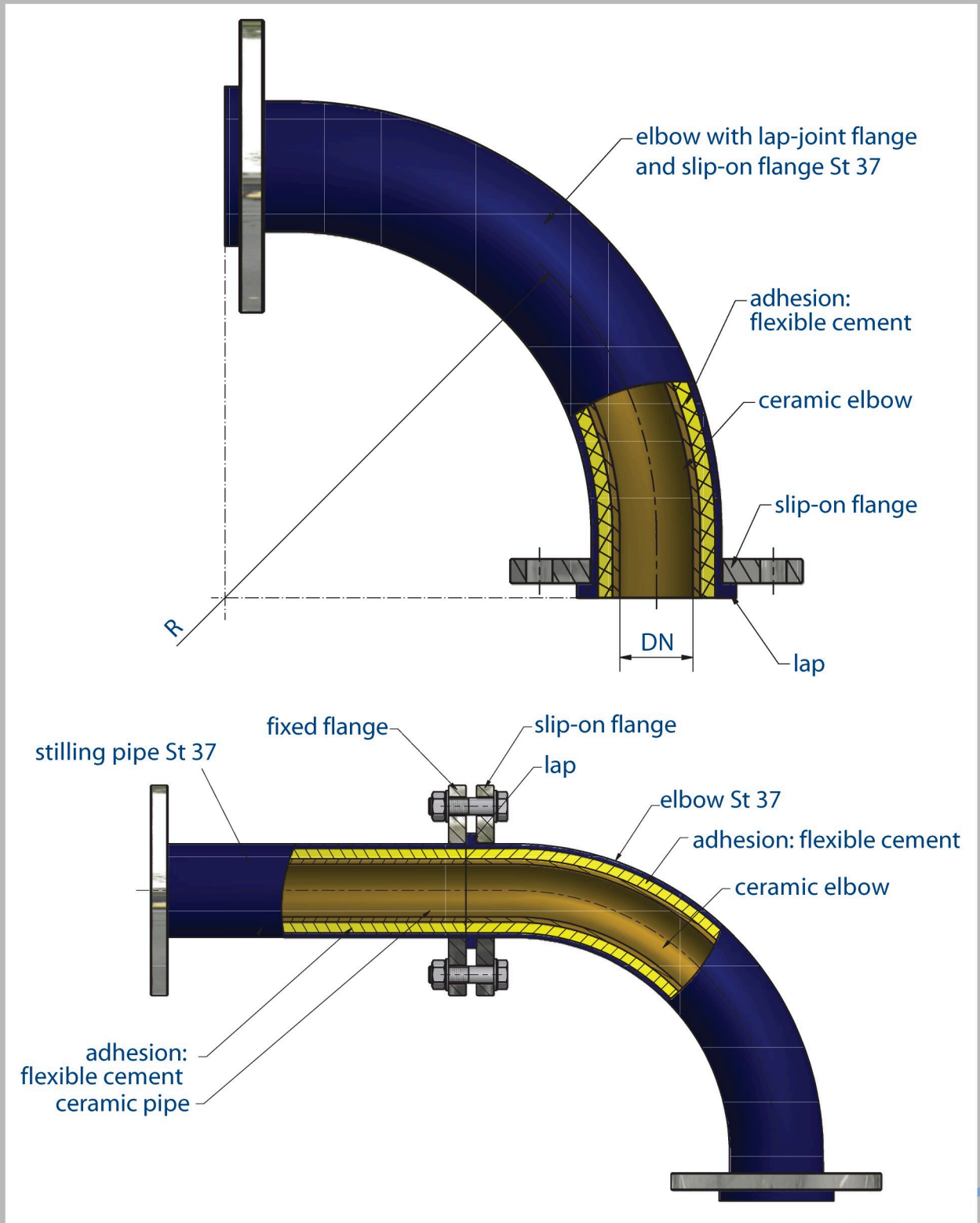

shipping address: Am Sinnerhoop 70 · 58285 Gevelsberg / Germany · Tel +49 2332 544360
 registered office: Deller Str. 16 · 58339 Breckerfeld / Germany · Tel +49 2338 5919710

website: <https://www.friedrich-gerke.de>
 e-mail: info@friedrich-gerke.de

Application

FG ceramic elbows and pipes

For greatest demands and requirements on Al₂O₃-ceramics
+ nominal diameter from DN 25 to DN 3000
+ available in jointless segment- and lining ceramics
+ concurrent nominal diameter with fixed flanges or slip-on flanges
+ equal- and unequal-sided construction
+ low weight compared to basalt-lining

In conjunction with a ceramic-stilling pipe you reach a minimization of granule trituration and a reduction of dust proportion.

By using ceramics the operational lifetime is increased many times over compared to conventional utilization material.

The economical solution to reduce operating expenditures!

Specifications

1. Turbulences inside and after venting the redirection device
2. Stabilization of materialflow inside stilling pipe
3. Stabilized flow of material inside the succeeding pipe

Construction of a ceramic pipe bend
pipe bend outside

- + regular steel
- + stainless steel in different grades
- + according to size and radius: segmented to DIN 2605 (ISO) primed ca. 40m, body-colour RAL 5014 (pigeon blue) / pale / custom

pipe bend inside

- + standard ceramic-inliner Al₂O₃-ceramic / jointless / segmented
- + in range of high temperature SIC-ceramic / jointless / segmented
- + buffer material: cement / flex. cement / silicone / flex. synthetic PUR

special models

- + pipe bends (inside and outside) and joint components can be coated with caustic solution / acid-resistant
- + pipe bends in lightweight design (food industry)
- + inliner coated with GFRP-enclosure - advantage: low weight

joints

- + concurrent nominal diameter for lap-joint flange, slip-on flange and fixed flange
- + adapter flanges for different flange joints
- + customer requested joints: Camlock / Storz / Clamp

shipping address: Am Sinnerhoop 70 · 58285 Gevelsberg / Germany · Tel +49 2332 544360
registered office: Deller Str. 16 · 58339 Breckerfeld / Germany · Tel +49 2338 5919710

website: <https://www.friedrich-gerke.de>
e-mail: info@friedrich-gerke.de

Specification sheet

FG ceramic elbows and pipes

Sizes of pipe bend

+ dimensions DN25 - DN150 standard jointless / segmented

+ dimensions DN25 - DN3000 lining with Al₂O₃ - mosaic ceramic / Al₂O₃ - panel ceramic (custom) radii

+ R 150 – R 1500 mm in one piece

+ pipe bends over R 1500 > division depending on degree

examples:

pipe bend DN 100, 90°, R 2000, concurrent nominal diameter

pipe bend DN 100, 30°, R 2000, concurrent nominal diameter

pipe bend DN 100, 45°, R 2000, concurrent nominal diameter

standard joints

+ inside internal pattern of divided pipe bend

+ fixed flange for positioning

+ in associated body concurrent nominal diameter for lap-joint- and slip-on flange

